

**IEEE/PES TRANSFORMERS COMMITTEE**  
**www.transformerscommittee.org**  
**Spring 2017 Meeting; April 2-6**  
**Hosted by Entergy**  
**Astor Crowne Plaza Hotel; New Orleans, Louisiana USA**

-- See Page 5 for a key to abbreviations.

-- Room locations designated as (1), (2), (M2), etc., indicate the "button to press" in the elevator. For instance, a room on (1) is located on First Floor/Lobby, and a room on (M2) is located on Second Floor Mezzanine.

<u>DATE/TIME</u>	<u>ACTIVITY</u>	<u>SUB-COM</u>	<u>ACTIVITY CHAIR</u>	<u>ROOM CAP/ARR/AV</u>	<u>MEETING ROOM</u>
<b>Thursday, March 30</b>					
8:00 am - 5:00 pm >	IEC MT 60076-4 Impulse Test Guide	++	T. Hochanh	10 BD	Royal (M2)
<b>Friday, March 31</b>					
> 8:00 am - 5:00 pm	IEC MT 60076-4 Impulse Test Guide	++	T. Hochanh	10 BD	Royal (M2)
<b>Saturday, April 1</b>					
	No Technical Tours planned				
8:00 am - 5:00 pm	WG Step-Voltage Regulators C57.16/60076-21	Dist	C. Colopy	20 US	Bourbon (M2)
6:15 pm until ??	<u>Early Bird Event</u> : Dinner, Music & Fun at BB King's Blues Club. Advance on-line registration necessary. -- Meet in hotel lobby at 6:15 pm. We will walk together to BB King's (5-10 minute walk). -- Cash bar opens at 6:30 pm; dinner served at 6:45. Live music begins ~7:00 pm. See flyer for details.				
<b>Sunday, April 2</b>					
	No Technical Tours planned				
1:00 pm - <u>5:30 pm</u>	Meeting Registration				Grand Ballroom Foyer (2)
2:00 pm - 5:30 pm	Administrative SC -- Closed meeting, by invitation only	Admin	S. Antosz	24 US w/buffet	Toulouse AB (M2)
2:00 pm - 5:30 pm	NEMA Transformers -- Closed meeting, by invitation only	++	J. Caskey	20 US w/beverage cart	Bourbon (M2)
6:00 pm - 8:00 pm	Welcome Reception			500 Reception	Grand Ballroom (2)
<b>Monday, April 3 -- Monday Breaks Sponsored by Brockhaus Measurements **</b>					
7:00 am - 5:00 pm	Meeting Registration				Grand Ballroom Foyer (2)
<u>7:00 am</u> - 7:50 am	Newcomers Orientation -- Breakfast Meeting; arrive early! -- Newcomers & Guests are encouraged to attend!		S. McNelly	<u>60 CL</u> w/buffet in room	St. Charles AB (1)
<u>7:00 am</u> - 7:50 am	Distribution SC Leaders Coordination -- Closed breakfast meeting, by invitation only		S. Shull	12 BD	St. Louis (M2)
7:00 am - 8:00 am	Breakfast - Attendees (no spouses/companions please)			272 RT (8/tbl) w/buffet in Gallery	Astor Ballroom (2)
8:00 am - 9:30 am	Breakfast - Spouses/Companions (no meeting attendees please)			80 RT (8/tbl)	Bourbon House Restaurant (1)
9:15 am - 5:00 pm	<u>Spouses/Companions Tour</u> : Houmas House Plantation & Swamp Tour. Advance registration required. -- Bus departs front of hotel at 9:15 am, and returns ~5:00 pm. Includes lunch. See flyer for details.				
8:00 am - 9:15 am >	Opening Session -- <u>All attendees</u> are encouraged to attend -- See separate document for meeting agenda -- Attendance required to maintain Committee Member status.		S. Antosz	550 MX S1	Grand Ballroom ABCD (2)
9:15 am - 9:30 am	Break (beverages only)				Foyers, Floors 2 & M2

\*\* Contact Ed Smith (edsmith@ieee.org) if you are interested in sponsoring a coffee break at a future meeting.

<u>DATE/TIME</u>	<u>ACTIVITY</u>	<u>SUB-COM</u>	<u>ACTIVITY CHAIR</u>	<u>ROOM CAP/ARR/AV</u>	<u>MEETING ROOM</u>
<b>Monday, April 3 (continued)</b>					
	<del>WG Thermal Evaluation of Insulation Systems, Dry Type C57.12.60</del>	Dry	moved to Tuesday 1:45 pm		
9:30 am - 10:45 am	--	--	--	60 MX (30 CL + 30 TH)	Iberville (M2)
9:30 am - 10:45 am	WG Submersible Transf. C57.12.24	UTNP	G. Termini	80 MX	Toulouse AB (M2)
9:30 am - 10:45 am	TF External Dielectric Clearances	DiTests	E. Davis	100 MX (60 CL + 40 TH)	St. Charles AB (1)
9:30 am - 10:45 am	WG Tertiary/Stabilizing Windings PC57.158	PCS	E. Betancourt	175 MX S3	Grand Ballroom AB
9:30 am - 10:45 am	TF Consolidation of Insulating Fluid Guides	IF	T. Prevost	175 MX S3	Grand Ballroom D
9:30 am - 10:45 am	TF Transformer Efficiency and Loss Evaluation (DOE Activity)	Dist	P. Hopkinson	200 MX S1	Grand Ballroom C
10:45 am - 11:00 am	<i>Break (beverages only)</i>			Foyers, Floors 2 & M2	
11:00 am - 12:15 pm	WG Ventilated Dry Type PC57.12.51	Dry	S. Som	60 MX	Iberville (M2)
11:00 am - 12:15 pm	--	--	--	80 MX	Toulouse AB (M2)
11:00 am - 12:15 pm	WG Overhead Distr. Transf. C57.12.20	Dist	A. Traut	100 MX	St. Charles AB (1)
11:00 am - 12:15 pm	WG Control Cabinets PC57.148	Power	J. Watson	175 MX S3	Grand Ballroom AB
11:00 am - 12:15 pm	WG Moisture in Insulation PC57.162	IL	T. Prevost	175 MX S3	Grand Ballroom D
11:00 am - 12:15 pm	TF PCS Rev. to Test Code C57.12.90	PCS	H. Sahin	200 MX S1	Grand Ballroom C
12:15 pm - 1:30 pm	<u>Lunch Meeting:</u> Standards Development Review		J. Graham	240 RT (7/tbl)	Astor Ballroom (2)
	-- <u>Everyone</u> welcome to attend. All SC/WG/TF leaders are <u>highly encouraged</u> to attend.				
	-- Doors open ~12:00 pm. Come early, get a good seat, and start eating.				
	-- Advance registration necessary. No paper tickets. Admission verified with name badge at the door.				
	-- Anyone can join us for this luncheon, and sit & listen to the presentation, without eating lunch.				
	Suggested time to arrive for only the presentation (without lunch) is 12:30 pm.				
1:45 pm - 3:00 pm	WG Dry Type Gen. Require. C57.12.01	Dry	C. Ballard	60 MX	Iberville (M2)
1:45 pm - 3:00 pm	WG Sec. Network Protectors C57.12.44	UTNP	M. Faulkner	80 MX	Toulouse AB (M2)
1:45 pm - 3:00 pm	WG 1-ph Padmount Dist Transf C57.12.38	Dist	A. Ghafourian	100 MX	St. Charles AB (1)
1:45 pm - 3:00 pm	WG Thru-Fault Current Duration PC57.109	PCS	V. Mehrotra	175 MX S3	Grand Ballroom AB
1:45 pm - 3:00 pm	WG Installation of Power Transf. C57.93	Power	M. Lau	175 MX S3	Grand Ballroom D
1:45 pm - 3:00 pm	TF Audible Sound Revision to Test Code	PCS	R. Girgis	200 MX S1	Grand Ballroom C
3:00 pm - 3:15 pm	<i>Break (beverages and treats)</i>			Foyers, Floors 2 & M2	
	<del>WG Natural Ester Based Fluids C57.147</del>	IF	Work is complete.		
	<del>WG Transformer Capability with Non-sinusoidal Loads PC57.140</del>	PCS	Work is complete.		
	<del>WG Dielectric Freq. Response PC57.161</del>	DiTests	Balloting on final document.		
3:15 pm - 4:30 pm	<b>SC HVDC Converter Transformers and Smoothing Reactors</b>	HVDC	M. Sharp	60 MX	Iberville (M2)
3:15 pm - 4:30 pm	--	--	--	80 MX	Toulouse AB (M2)
3:15 pm - 4:30 pm	WG 3-ph Padmount Dist Transf. C57.12.34	Dist	R. Stahara	100 MX	St. Charles AB (1)
3:15 pm - 4:30 pm	TF PD Limits <b>(New!)</b>	DiTests	V. Mehrotra	175 MX S3	Grand Ballroom AB
3:15 pm - 4:30 pm	WG Transformer Monitoring C57.143	Power	M. Spurlock	175 MX S3	Grand Ballroom D
3:15 pm - 4:30 pm	--	--	--	200 MX S1	Grand Ballroom C
4:30 pm - 4:45 pm	<i>Break (beverages only)</i>			Foyers, Floors 2 & M2	
4:45 pm - 6:00 pm	WG Dry Type Reactors PC57.16	Dry	A. Del Rio	60 MX	Iberville (M2)
4:45 pm - 6:00 pm	--	--	--	80 MX	Toulouse AB (M2)
4:45 pm - 6:00 pm	WG Step-Voltage Regulators C57.15 / 60076-21	Dist	C. Colopy	100 MX	St. Charles AB (1)
4:45 pm - 6:00 pm	WG PD in Bushings & PT/CTs PC57.160	DiTests	T. Hochanh	175 MX S3	Grand Ballroom AB
4:45 pm - 6:00 pm	WG Life Extension C57.140	Power	P. Boman	175 MX S3	Grand Ballroom D
4:45 pm - 6:00 pm	TF PCS Revisions to C57.12.00	PCS	T. Ansari	200 MX S1	Grand Ballroom C

No technical tours or socials planned

<u>DATE/TIME</u>	<u>ACTIVITY</u>	<u>SUB-COM</u>	<u>ACTIVITY CHAIR</u>	<u>ROOM CAP/ARR/AV</u>	<u>MEETING ROOM</u>
<b>Tuesday, April 4 -- Tuesday Breaks Sponsored by SPX Transformer Solutions **</b>					
7:00 am - 11:30 am	Meeting Registration				Grand Ballroom Foyer (2)
7:00 am - 8:00 am	Breakfast - Attendees (no spouses/companions please)			272 RT (8/tbl) w/buffet in Gallery	Astor Ballroom (2)
8:00 am - 9:30 am	Breakfast - Spouses/Companions (no meeting attendees please)			80 RT (8/tbl)	Bourbon House Restaurant (1)
<u>7:00 am</u> - 7:50 am	EL&P Delegation (End-users only please) -- Breakfast Meeting; arrive early		J. Murphy	<u>60 CL</u> w/buffet in room	St. Charles AB (1)
9:15 am - 4:15 pm	<u>Spouses/Companions Tour</u> : Mardi Gras World & New Orleans Cooking School. Advance registration required. -- Bus departs front of hotel at 9:15 am, and returns ~4:15 pm. Lunch at cooking school. See flyer for details.				
8:00 am - 9:15 am	WG Station Service Volt. Transf. C57.13.8	IT	D. Wallace	60 MX	Iberville (M2)
8:00 am - 9:15 am	WG Enclosure Integrity C57.12.28, C57.12.29, C57.12.31, C57.12.32	Dist	D. Mulkey	80 MX	Toulouse AB (M2)
8:00 am - 9:15 am	--	--	--	100 MX (60 CL + 40 TH)	St. Charles AB (1)
8:00 am - 9:15 am	TF Limits for Winding Insulation PF/Resistance	DiTests	S. Tarlapally	175 MX S3	Grand Ballroom AB
8:00 am - 9:15 am	WG Dry Type PD Detection PC57.124	Dry	T. Prevost	175 MX S3	Grand Ballroom D
8:00 am - 9:15 am	WG Revision to C57.12.10	Power	G. Hoffman	200 MX S1	Grand Ballroom C
9:15 am - 9:30 am	<i>Break (beverages only)</i>			Foyers, Floors 2 & M2	
9:30 am - 10:45 am	WG Tests for Instrument Transf. C57.13.5	IT	P. Riffon	60 MX	Iberville (M2)
9:30 am - 10:45 am	WG 1-Ph Submersible Transf. C57.12.23	UTNP	A. Traut	80 MX	Toulouse AB (M2)
9:30 am - 10:45 am	--			100 MX	St. Charles AB (1)
9:30 am - 10:45 am	WG GSU Bushings PC57.19.04	Bush	S. Digby	175 MX S3	Grand Ballroom AB
9:30 am - 10:45 am	WG Shunt Reactors C57.21	PCS	S. Som	175 MX S3	Grand Ballroom D
9:30 am - 10:45 am	WG Wind Turbine Transf. P60076-16	PCS	P. Hopkinson	200 MX S1	Grand Ballroom C
10:45 am - 11:00 am	<i>Break (beverages only)</i>			Foyers, Floors 2 & M2	
	<del>WG Loss Evaluation Guide C57.120</del>	<del>PCS</del>	Will not meet.	Work complete.	
11:00 am - 12:15 pm	WG PLC Caps & CCVTs PC57.13.9	IT	Z. Roman	60 MX	Iberville (M2)
11:00 am - 12:15 pm	WG Liquid-immersed Secondary Network Transformers C57.12.40	UTNP	B. Klaponski	80 MX	Toulouse AB (M2)
11:00 am - 12:15 pm	WG PD Acoustic Detection C57.127	DiTests	D. Gross	100 MX	St. Charles AB (1)
11:00 am - 12:15 pm	WG Distrib. Transf. Bushings PC57.19.02	Bush	S. Shull	175 MX S3	Grand Ballroom AB
11:00 am - 12:15 pm	WG Semiconductor Power Rectifier Transformers C57.18.10	PCS	S. Kennedy	175 MX S3	Grand Ballroom D
11:00 am - 12:15 pm	WG Transportation Issues PC57.150	Power	G. Anderson	200 MX S1	Grand Ballroom C
12:15 pm - 1:30 pm	<u>Awards Luncheon</u>		D. Platts	240 RT (7/tbl)	Astor Ballroom (2)
	-- Doors open ~12:00 pm. <u>Come early</u> , get a good seat, and start eating.				
	-- Advance registration necessary. No paper tickets. Admission verified with name badge at the door.				
	<b>All meeting attendees are encouraged to attend this luncheon.</b>				
	<b>It's a great way to show your appreciation and help us recognize our accomplishments.</b>				
	<del>WG DPV Grid Transformers PC57.159</del>	<del>PCS</del>	Work is complete.		
1:45 pm - 3:00 pm	WG 3-ph Transf. Connections PC57.105	PCS	R. Verdolin	60 MX	Iberville (M2)
1:45 pm - 3:00 pm	WG Distr. Substation Transf. C57.12.36	Dist	J. Murphy	80 MX	Toulouse AB (M2)
1:45 pm - 3:00 pm	WG Thermal Evaluation of Insulation Systems, Dry Type C57.12.60	Dry	R. Wicks	100 MX	St. Charles AB (1)
1:45 pm - 3:00 pm	WG Std Require for Bushings C57.19.01	Bush	S. Zhang	175 MX S3	Grand Ballroom AB
1:45 pm - 3:00 pm	WG Tap Changers 60214-1-57-131	Power	C. Colopy	175 MX S3	Grand Ballroom D
1:45 pm - 3:00 pm	TF Revision to Low Frequency Tests	DiTests	B. Griesacker	200 MX S1	Grand Ballroom C
3:00 pm - 3:15 pm	<i>Break (beverages and Pretzels!)</i>			Foyers, Floors 2 & M2	

\*\* Contact Ed Smith (edsmith@ieee.org) if you are interested in sponsoring a coffee break at a future meeting.

<u>DATE/TIME</u>	<u>ACTIVITY</u>	<u>SUB-COM</u>	<u>ACTIVITY CHAIR</u>	<u>ROOM CAP/ARR/AV</u>	<u>MEETING ROOM</u>
<b>Tuesday, April 4 (continued)</b>					
	<del>WG Dry Type Reactors PC57.146</del>	Dry	moved to Monday 4:45 pm		
3:15 pm - 4:30 pm	WG Std Terminal Markings C57.12.70	Stds	S. Shull	60 MX	Iberville (M2)
3:15 pm - 4:30 pm	--	--	--	80 MX	Toulouse AB (M2)
3:15 pm - 4:30 pm	WG High-Temp Insulat. Materials, P-1276	IL	R. Wicks	100 MX	St. Charles AB (1)
3:15 pm - 4:30 pm	WG Bushing Applicat. Guide C57.19.100	Bush	T. Spitzer	175 MX S3	Grand Ballroom AB
3:15 pm - 4:30 pm	WG Tap Changer Applicat. Guide 60214-2	Power	C. Colopy	175 MX S3	Grand Ballroom D
3:15 pm - 4:30 pm	TF Switching Transients Induced by Transf/Breaker Interaction PC57.142	PCS	J. McBride	200 MX S1	Grand Ballroom C
4:30 pm - 4:45 pm	<i>Break (beverages only)</i>			Foyers, Floors 2 & M2	
4:45 pm - 6:00 pm	WG Std Transf. Terminology C57.12.80	Stds	C. Clairborne	60 MX	Iberville (M2)
4:45 pm - 6:00 pm	WG Tank Pressure Coordinat. C57.12.39	Dist	C. Gaytan	80 MX	Toulouse AB (M2)
4:45 pm - 6:00 pm	WG Dry Type Test Code C57.12.91	Dry	D. Foster	100 MX	St. Charles AB (1)
4:45 pm - 6:00 pm	WG Short Circuit Withstand PC57.164	PCS	S. Patel	175 MX S3	Grand Ballroom AB
4:45 pm - 6:00 pm	WG Gas Interpretation Guide C57.104	IF	C. Beauchemin	175 MX S3	Grand Ballroom D
4:45 pm - 6:00 pm	TF Revisions to Impulse Test Sections of C57.12.00 and C57.12.90	DiTests	P. Riffon	200 MX S1	Grand Ballroom C
No technical tours or socials planned					
<b>Wednesday, April 5 -- Wednesday Breaks Sponsored by HICO America **</b>					
No Meeting Registration, No Technical Tours, No Spouse/Companion Tours					
7:00 am - 8:00 am	Breakfast - Attendees (no spouses/companions please)			272 RT (8/tbl)	Astor Ballroom (2)
8:00 am - 9:30 am	Breakfast - Spouses/Companions (no meeting attendees please)			80 RT (8/tbl)	Bourbon House Rest
<u>7:00 am</u> - 7:50 am	<b>SC Meetings Planning</b>	Mtgs	G. Anderson	30 CL w/buffet in room	Iberville (M2)
<u>7:00 am</u> - 8:30 am	IEC TC-14 Technical Advisory Group -- Breakfast Meeting; arrive early -- All interested individuals welcome	++	P. Hopkinson	60 CL w/buffet in room	St. Charles AB (1)
8:00 am - 9:15 am	<b>SC Instrument Transformers</b>	IT	R. McTaggart	60 MX	Toulouse AB (M2)
8:00 am - 9:15 am	<b>SC Insulation Life</b>	IL	S. Kennedy	375 MX S1 (175+200)	Grand Ballroom AB+C (2)
9:15 am - 9:30 am	<i>Break (beverages only)</i>			Grand Ballroom Foyer only	
9:30 am - 10:45 am	<b>SC Bushings</b>	Bush	P. Zhao	175 MX S3	Grand Ballroom D
9:30 am - 10:45 am	<b>SC Distribution Transformers</b>	Dist	S. Shull	375 MX S1	Grand Ballroom ABC
10:45 am - 11:00 am	<i>Break (beverages only)</i>			Grand Ballroom Foyer only	
11:00 am - 12:15 pm	<b>SC UG Transf. &amp; Network Protectors</b>	UTNP	D. Mulkey	60 MX	Toulouse AB (M2)
11:00 am - 12:15 pm	<b>SC Dielectric Tests</b>	DiTests	A. Varghese	375 MX S1	Grand Ballroom ABC
12:15 pm - 1:30 pm	Lunch (on your own)				
1:30 pm - 2:45 pm	<b>SC Dry Type Transformers</b>	Dry	C. Johnson	60 MX	Toulouse AB (M2)
1:30 pm - 2:45 pm	<b>SC Power Transformers</b>	Power	B. Griesacker	350 MX S1	Grand Ballroom ABC
2:45 pm - 3:00 pm	<i>Break (beverages and treats)</i>			Grand Ballroom Foyer only	
3:00 pm - 4:15 pm	<b>SC Insulating Fluids</b>	IF	D. Wallach	175 MX S3	Grand Ballroom D
3:00 pm - 4:15 pm	<b>SC Performance Characteristics</b>	PCS	E. teNyenhuis	375 MX S1	Grand Ballroom ABC
4:15 pm - 4:30 pm	<i>Break (beverages only)</i>				
4:30 pm - 5:45 pm	<b>SC Standards</b>	Stds	J. Murphy	175 MX S3	Grand Ballroom D
6:30 pm - 9:30 pm	<b>Evening Social:</b> Dinner at the Audubon Aquarium of the Americas. Advance registration is necessary. -- Paper tickets will not be provided. Admission confirmed with list at entrance of Aquarium. -- Approx 5-10 minute walk from hotel; shuttle bus available if desired. -- Event begins at 6:30 pm with reception and music at entrance of Aquarium. -- Exhibits, cash bar and 1st floor gift shop also open at 6:30 pm. Dinner begins at 7:30 pm. -- Exhibits stay open until 9:30 pm. Gift shop closes at 7:30 pm.				

\*\* Contact Ed Smith (edsmith@ieee.org) if you are interested in sponsoring a coffee break at a future meeting.

**KEY**

Note: A PC projector will be furnished in each meeting room. Arrive early to ensure equipment operates/syncs correctly.  
 > -- activity continued into another session / from another session BD = boardroom; US = U-shape  
 ++ -- not a Transformers Committee activity TBD = "To Be Determined" RT = multiple roundtables  
 S1 = special sound set-up, w/podium & lapel mics, table mics, stand mics at mid-room CL = classroom seating (w/head table for 2)  
 S2 = stand mic in front only; S3 = one stand mic in front & stand mic(s) at mid-room TH = theater seating (w/head table for 2)  
 MX = mix classroom & theater (w/head table)

SUBCOMMITTEES					
Admin	Administrative	HVDC	HVDC Converter Transformers and Smoothing Reactors	Mtgs	Meetings
Bush	Bushings			PCS	Performance Characteristics
DiTests	Dielectric Tests	IF	Insulation Fluids	Power	Power Transformers
Dist	Distribution Transformers	IL	Insulation Life	UTNP	Underground Transformers and Network Protectors
Dry	Dry Type Transformers	IT	Instrument Transformers		
				Stds	Standards

**Thursday, April 6**

No Meeting Registration, No Spouses/Companions Tours or Technical Tours planned					
7:00 am - 8:30 am	Breakfast - Attendees (no spouses/companions please)			272 RT (8/tbl)	Astor Ballroom (2)
8:00 am - 9:30 am	Breakfast - Spouses/Companions (no meeting attendees please)			80 RT (8/tbl)	Bourbon House Restaurant (1)
8:00 am - 9:15 am	Technical Presentation #1: "Field Testing of LTCs". See flyer on website. **			375 MX S1	Grand Ballroom ABC (2)
9:15 am - 9:30 am	Break (beverages only)				Grand Ballroom Foyer only
9:30 am - 10:45 am	Technical Presentation #2: "Aging Markers for Estimation of Paper Degradation". See flyer on website. **			375 MX S1	Grand Ballroom ABC (2)
10:45 am - 11:00 am	Break (beverages only)				Grand Ballroom Foyer only
11:00 am - 12:00 pm	Closing Session -- All attendees are encouraged to attend -- See separate document for meeting agenda		S. Antosz	375 MX S1	Grand Ballroom ABC (2)
Lunch on your own					
1:00 pm - 5:00 pm	--	--	--	10 BD	Royal (M2)

**Friday, April 7**

No Meetings, No Technical Tours					
---------------------------------	--	--	--	--	--

\*\* Contact Tom Prevost (tprevost@ieee.org) if you are interested in making a technical presentation at a future meeting.

**FUTURE COMMITTEE MEETINGS**

- Fall 2017: October 29 to November 2; Louisville, Kentucky USA
- Spring 2018: March 25-29; Pittsburgh, Pennsylvania USA -- Our 100th Year Anniversary Celebration!
- Fall 2018: October 14-18 or 21-25, or November 4-8; USA Location (to be determined)
- Spring 2019: March 10-14 or 17-21 or 24-28; USA Location (to be determined)

# Astor Crowne Plaza Hotel

739 Canal Street (corner of Canal and Bourbon Streets)  
New Orleans, Louisiana USA  
+1.504.962.0500

## SECOND FLOOR MEZZANINE (M2)

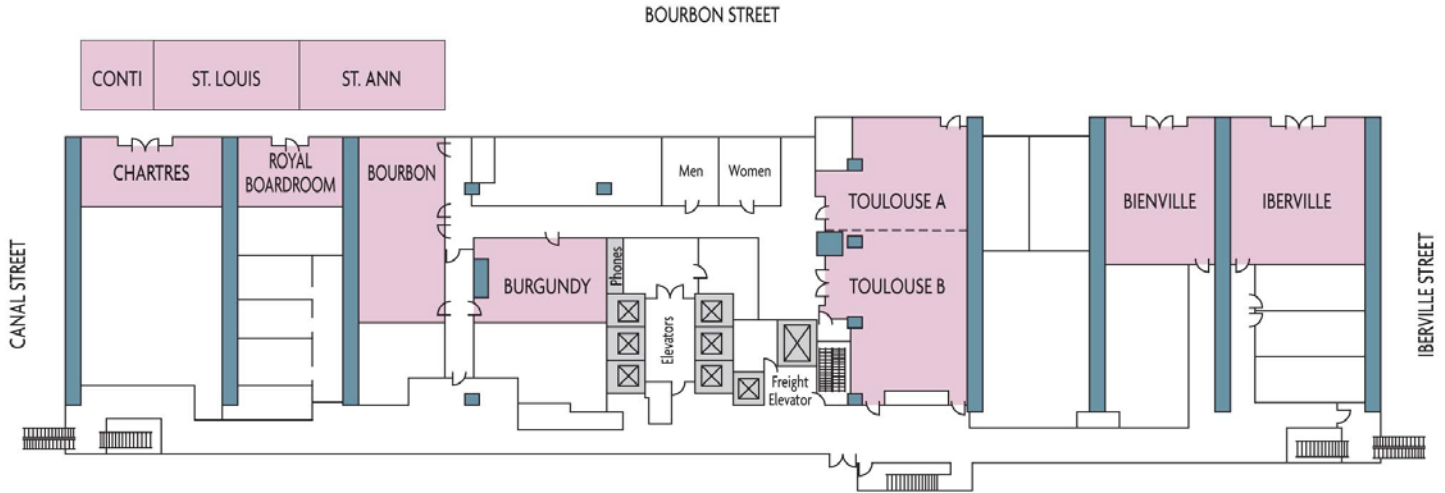

## SECOND FLOOR (2)

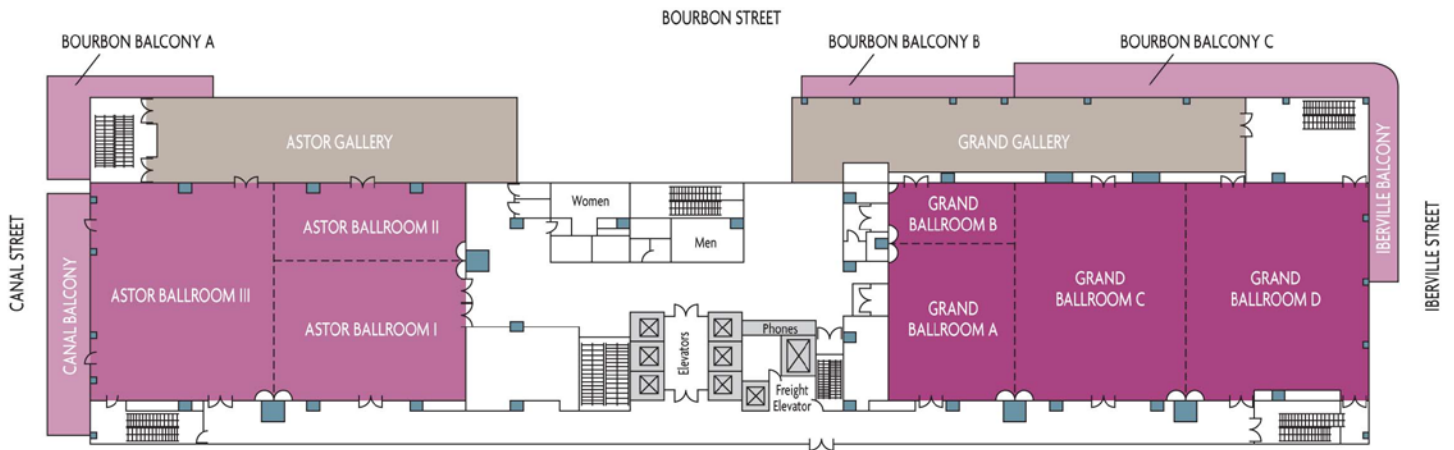

## FIRST FLOOR / LOBBY (1)

