

IEEE/PES TRANSFORMERS COMMITTEE
www.transformerscommittee.org
Fall 2017 Meeting; October 29 to November 2
Louisville Downtown Marriott Hotel; Louisville, Kentucky USA

-- See Page 5 for a key to abbreviations.

-- Room locations designated as (1), (2), etc., indicate the "button to press" in the elevator. For instance, a room on (1) is located on First Level, and a room on (2) is located on Second Level.

<u>DATE/TIME</u>	<u>ACTIVITY</u>	<u>SUB-COM</u>	<u>ACTIVITY CHAIR</u>	<u>ROOM CAP/ARR/AV</u>	<u>MEETING ROOM</u>
Friday, October 27					
No Meetings, Socials or Technical Tours					
Saturday, October 28					
No Meetings or Technical Tours					
6:15 pm until ??	<u>Early Bird Event:</u> Dinner, Bowling & Fun at The Sports & Social Club. Advance on-line registration necessary. -- Meet in hotel lobby at 6:15 pm. We will walk together to S&SC (5-minute walk). -- Buffet dinner begins at 6:30 pm. Bowling lanes open at 7:30 pm. See flyer for details.				
Sunday, October 29					
No Technical Tours planned					
1:00 pm - <u>5:30 pm</u>	Meeting Registration			Marriott Ballroom Foyer (2)	
2:00 pm - 5:30 pm	Administrative SC -- Closed meeting, by invitation only	Admin	S. Antosz	24 US w/buffet	Bluegrass 1+2 (2)
2:00 pm - 5:30 pm	NEMA Transformers -- Closed meeting, by invitation only	++	J. Caskey	20 US w/beverage cart	Rose (2)
6:00 pm - 8:00 pm	Welcome Reception			500 Reception	Marriott Ballroom 5+6 (2)
Monday, October 30 -- Monday Breaks Sponsored by Phenix Technologies **					
7:00 am - 5:00 pm	Meeting Registration			Marriott Ballroom Foyer (2)	
<u>7:00 am</u> - 7:50 am	Newcomers Orientation -- Breakfast Meeting; arrive early! -- Newcomers & Guests are encouraged to attend!		S. McNelly	100 CL w/buffet in room	Kentucky F+G (1)
<u>7:00 am</u> - 7:50 am	Distribution SC Leaders Coordination -- Closed breakfast meeting, by invitation only		S. Shull	12 BD w/buffet in room	Thoroughbred (2)
7:00 am - 8:00 am	Breakfast - Attendees (no spouses/companions please)			280 RT (8/tbl)	Kentucky Ballroom A-E (1)
8:00 am - 9:30 am	Breakfast - Spouses/Companions (no meeting attendees please)			80 RT (8/tbl)	Bluegrass 1+2 (2)
9:15 am - 3:00 pm	<u>Spouses/Companions Tour:</u> Mansions, Living History, Hot Browns & Julep. Advance registration required. -- Bus departs front of hotel at 9:15 am, and returns ~3:00 pm. Includes lunch. See flyer for details.				
8:00 am - 9:15 am >	Opening Session -- All attendees are encouraged to attend -- See separate document for meeting agenda -- Attendance required to maintain Committee Member status.		S. Antosz	600 MX S1 (240 CL+360 TH)	Marriott Ballroom 5+6 (2)
9:15 am - 9:30 am	<i>Break (beverages only)</i>			First & Second Levels	

** Contact Ed Smith (edsmith@ieee.org) if you are interested in sponsoring a day of coffee breaks at a future meeting.

<u>DATE/TIME</u>	<u>ACTIVITY</u>	<u>SUB-COM</u>	<u>ACTIVITY CHAIR</u>	<u>ROOM CAP/ARR/AV</u>	<u>MEETING ROOM</u>
Monday, October 30 (continued)					
9:30 am - 10:45 am	WG Submersible Transf. C57.12.24	UTNP	G. Termini	90 MX (50 CL + 40 TH)	Kentucky F (1)
9:30 am - 10:45 am	TF LTC Field Tests - NEW!	PCS	M. Ferreira	90 MX	Kentucky G (1)
9:30 am - 10:45 am	TF External Dielectric Clearances	DiTests	E. Davis	140 MX S3	Marriott 1-3 (2)
9:30 am - 10:45 am	WG Tertiary/Stabilizing Windings PC57.158	PCS	E. Betancourt	140 MX S3	Marriott 7-9 (2)
9:30 am - 10:45 am	TF Consolidation of Insulating Fluid Guides	IF	T. Prevost	220 MX S1	Marriott 5 (2)
9:30 am - 10:45 am	TF Transformer Efficiency and Loss Evaluation (DOE Activity)	Dist	P. Hopkinson	220 MX S1 (120 CL+100 TH)	Marriott 6 (2)
10:45 am - 11:00 am	<i>Break (beverages only)</i>				First & Second Levels
11:00 am - 12:15 pm	WG Ventilated Dry Type PC57.12.51	Dry	S. Som	90 MX	Kentucky F (1)
11:00 am - 12:15 pm	--	--	--	90 MX	Kentucky G (1)
11:00 am - 12:15 pm	WG Overhead Distr. Transf. C57.12.20	Dist	A. Traut	140 MX S3	Marriott 1-3 (2)
11:00 am - 12:15 pm	WG Control Cabinets PC57.148	Power	J. Watson	140 MX S3	Marriott 7-9 (2)
11:00 am - 12:15 pm	WG Moisture in Insulation PC57.162	IL	T. Prevost	220 MX S1	Marriott 5 (2)
11:00 am - 12:15 pm	TF PCS Rev. to Test Code C57.12.90	PCS	H. Sahin	220 MX S1	Marriott 6 (2)
12:15 pm - 1:30 pm	<u>Lunch Meeting:</u> Standards Development Review -- <u>Everyone</u> welcome to attend. All SC/WG/TF leaders are <u>highly encouraged</u> to attend. -- Doors open ~12:00 pm. Come early, get a good seat, and start eating. -- Advance registration necessary. No paper tickets. Admission verified with name badge at the door. -- Anyone can join us for this luncheon, and sit & listen to the presentation, without eating lunch. Suggested time to arrive for only the presentation (without lunch) is 12:30 pm.			J. Graham 245 RT (7/tbl)	Kentucky Ballroom A-E (1)
1:45 pm - 3:00 pm	WG Dry Type Gen. Require. C57.12.01	Dry	C. Ballard	90 MX	Kentucky F (1)
1:45 pm - 3:00 pm	WG Sec. Network Protectors C57.12.44	UTNP	M. Faulkner	90 MX	Kentucky G (1)
1:45 pm - 3:00 pm	WG 1-ph Padmount Dist Transf. C57.12.38	Dist	A. Ghafourian	140 MX S3	Marriott 1-3 (2)
1:45 pm - 3:00 pm	WG Thru-Fault Current Duration PC57.109	PCS	V. Mehrotra	140 MX S3	Marriott 7-9 (2)
1:45 pm - 3:00 pm	WG Installation of Power Transf. C57.93	Power	M. Lau	220 MX S1	Marriott 5 (2)
1:45 pm - 3:00 pm	TF Audible Sound Revision to Test Code	PCS	R. Girgis	220 MX S1	Marriott 6 (2)
3:00 pm - 3:15 pm	<i>Break (beverages and treats)</i>				First & Second Levels
3:15 pm - 4:30 pm	SC HVDC Converter Transformers and Smoothing Reactors	HVDC	M. Sharp	90 MX	Kentucky F (1)
3:15 pm - 4:30 pm	--	--	--	90 MX	Kentucky G (1)
3:15 pm - 4:30 pm	WG 3-ph Padmount Dist Transf. C57.12.34	Dist	R. Stahara	140 MX S3	Marriott 1-3 (2)
3:15 pm - 4:30 pm	--	--	--	140 MX S3	Marriott 7-9 (2)
3:15 pm - 4:30 pm	WG Transformer Monitoring C57.143	Power	M. Spurlock	220 MX S1	Marriott 5 (2)
3:15 pm - 4:30 pm	TF PD Limits for Factory Tests	DiTests	V. Mehrotra	220 MX S1	Marriott 6 (2)
4:30 pm - 4:45 pm	<i>Break (beverages only)</i>				First & Second Levels
4:45 pm - 6:00 pm	WG Life Extension C57.140	Power	Work is complete. Document is published.		
4:45 pm - 6:00 pm	WG Dry Type Reactors PC57.16	Dry	A. Del Rio	90 MX	Kentucky F (1)
4:45 pm - 6:00 pm	--	--	--	90 MX	Kentucky G (1)
4:45 pm - 6:00 pm	WG Step-Voltage Regulators C57.15 / 60076-21	Dist	C. Colopy	140 MX S3	Marriott 1-3 (2)
4:45 pm - 6:00 pm	WG PD in Bushings & PT/CTs PC57.160	DiTests	T. Hochanh	140 MX S3	Marriott 7-9 (2)
4:45 pm - 6:00 pm	--	--	--	220 MX S1	Marriott 5 (2)
4:45 pm - 6:00 pm	TF PCS Revisions to C57.12.00	PCS	T. Ansari	220 MX S1	Marriott 6 (2)
4:45 pm - 6:00 pm	<u>Technical Tours #1A & 1B:</u> FirstBuild Microfactory (identical tours on Monday & Tuesday). -- Advance registration necessary. Dinner on your own (eat before or after tour). See flyer for more info. -- Paper tickets will not be provided. Admission confirmed with RFID badge at bus (<u>bring your name badge!</u>). -- Tour #1A: Begin loading bus at hotel at ~4:30 pm and <u>depart promptly at 4:45 pm</u> . Return at ~6:00 pm. -- Tour #1B: Begin loading bus at hotel at ~6:00 pm and <u>depart promptly at 6:15 pm</u> . Return at ~7:30 pm.				

<u>DATE/TIME</u>	<u>ACTIVITY</u>	<u>SUB-COM</u>	<u>ACTIVITY CHAIR</u>	<u>ROOM CAP/ARR/AV</u>	<u>MEETING ROOM</u>
Tuesday, October 31; Happy Halloween! -- Tuesday Breaks Sponsored by R.L. Components					
7:00 am - 11:30 am	Meeting Registration			Marriott Ballroom	Foyer (2)
7:00 am - 8:00 am	Breakfast - Attendees (no spouses/companions please)			280 RT (8/tbl)	Kentucky Ballroom A-E (1)
8:00 am - 9:30 am	Breakfast - Spouses/Companions (no meeting attendees please)			80 RT (8/tbl)	Bluegrass 1+2 (2)
9:00 am - 4:00 pm Note early departure!	Spouses/Companions Tour: Horses, Hats and Derbies! Advance registration required. -- Bus departs front of hotel at 9:00 am, and returns ~4:00 pm. Includes lunch. See flyer for details.				
7:00 am - 7:50 am	EL&P Delegation (End-users only please) -- Breakfast meeting; arrive early		J. Murphy	40 CL w/buffet in foyer	Rose (2)
7:00 am - 7:50 am	100th Year Celebration Planning -- Breakfast meeting; arrive early	Mtgs	P. Balma	24 CL w/buffet in foyer	Filly (2)
	WG Revision to C57.12.10	Power		Work is complete. Document sent to Revcom.	
8:00 am - 9:15 am	WG Station Service Volt. Transf. C57.13.8	IT	D. Wallace	90 MX	Kentucky F (1)
8:00 am - 9:15 am	WG Enclosure Integrity C57.12.28, C57.12.29, C57.12.31, C57.12.32	Dist	D. Mulkey	90 MX	Kentucky G (1)
8:00 am - 9:15 am	TF Limits for Winding Insulation PF/Resistance	DiTests	S. Tarlapally	140 MX S3	Marriott 1-3 (2)
8:00 am - 9:15 am	WG Bushings Gen. Require. C57.19.00	Bush	P. Zhao	140 MX S3	Marriott 7-9 (2)
8:00 am - 9:15 am	WG Dry Type PD Detection PC57.124	Dry	T. Prevost	220 MX S1	Marriott 5 (2)
8:00 am - 9:15 am	WG Loading Guide PC57.91	IL	D. Wallach	220 MX S1	Marriott 6 (2)
9:15 am - 9:30 am	<i>Break (beverages only)</i>			First & Second Levels	
	WG GSU Bushings PC57.19.04	Bush		Balloting document.	
	WG Wind Turbine Transf. P60076-16	PCS		Work is complete. Report will be made in PCS meeting.	
9:30 am - 10:45 am	WG Tests for Instrument Transf. C57.13.5	IT	P. Riffon	90 MX	Kentucky F (1)
9:30 am - 10:45 am	WG 1-Ph Submersible Transf. C57.12.23	UTNP	A. Traut	90 MX	Kentucky G (1)
9:30 am - 10:45 am	WG Temp Measurement - NEW!	IL	P. McClure	140 MX S3	Marriott 1-3 (2)
9:30 am - 10:45 am	--	--	--	140 MX S3	Marriott 7-9 (2)
9:30 am - 10:45 am	WG Shunt Reactors C57.21	PCS	S. Som	220 MX S1	Marriott 5 (2)
9:30 am - 10:45 am	TF Condition Assessment Guide - New!	Power	B. Sparling	220 MX S1	Marriott 6 (2)
10:45 am - 11:00 am	<i>Break (beverages only)</i>			First & Second Levels	
11:00 am - 12:15 pm	WG PLC Caps & CCVTs PC57.13.9	IT	Z. Roman	90 MX	Kentucky F (1)
11:00 am - 12:15 pm	WG Liquid-immersed Secondary Network Transformers C57.12.40	UTNP	B. Klaponski	90 MX	Kentucky G (1)
11:00 am - 12:15 pm	WG PD Acoustic Detection C57.127	DiTests	D. Gross	140 MX S3	Marriott 1-3 (2)
11:00 am - 12:15 pm	WG Distrib. Transf. Bushings PC57.19.02	Bush	S. Shull	140 MX S3	Marriott 7-9 (2)
11:00 am - 12:15 pm	WG Semiconductor Power Rectifier Transformers C57.18.10	PCS	S. Kennedy	220 MX S1	Marriott 5 (2)
11:00 am - 12:15 pm	WG Transportation Issues C57.150	Power	G. Anderson	220 MX S1	Marriott 6 (2)
12:15 pm - 1:30 pm	<u>Awards Luncheon</u> -- Doors open ~12:00 pm. <u>Come early</u> , get a good seat, and start eating. -- Advance registration necessary. No paper tickets. Admission verified with name badge at the door. All meeting attendees are encouraged to attend this luncheon. It's a great way to show your appreciation and help us recognize our accomplishments.			D. Platts	245 RT (7/tbl) Kentucky Ballroom A-E (1)
	WG Std Require for Bushings C57.19.04	Bush		Work is complete. Document sent to Revcom.	
	WG Distr. Substation Transf. C57.12.36	Dist		Work is complete. Document sent to Revcom.	
	WG Tap Changers 60214-1-57-134	Power		Document on hold pending IEC joint review	
1:45 pm - 3:00 pm	WG 3-ph Transf. Connections PC57.105	PCS	R. Verdolin	90 MX	Kentucky F (1)
1:45 pm - 3:00 pm >	WG Tap Changer Applicat. Guide 60214-2 (above continued Thursday afternoon)	Power	C. Colopy	90 MX	Kentucky G (1)
1:45 pm - 3:00 pm	WG Thermal Evaluation of Insulation Systems, Dry Type C57.12.60	Dry	R. Wicks	140 MX S3	Marriott 1-3 (2)
1:45 pm - 3:00 pm	--	--	--	140 MX S3	Marriott 7-9 (2)
1:45 pm - 3:00 pm	--	--	--	220 MX S1	Marriott 5 (2)
1:45 pm - 3:00 pm	TF Revision to Low Frequency Tests	DiTests	B. Griesacker	220 MX S1	Marriott 6 (2)
3:00 pm - 3:15 pm	<i>Break (beverages <u>and Pretzels!</u>)</i>			First & Second Levels	

<u>DATE/TIME</u>	<u>ACTIVITY</u>	<u>SUB-COM</u>	<u>ACTIVITY CHAIR</u>	<u>ROOM CAP/ARR/AV</u>	<u>MEETING ROOM</u>
Tuesday, October 31 (continued)					
3:15 pm - 4:30 pm	WG Std Terminal Markings C57.12.70	Stds	S. Shull	90 MX	Kentucky F (1)
3:15 pm - 4:30 pm	WG Instrument Transf. Tests PC57.13.2	IT	T. Sizemore	90 MX	Kentucky G (1)
3:15 pm - 4:30 pm	WG High-Temp Insulat. Materials, P-1276	IL	R. Wicks	140 MX S3	Marriott 1-3 (2)
3:15 pm - 4:30 pm	WG Bushing Applicat. Guide C57.19.100	Bush	T. Spitzer	140 MX S3	Marriott 7-9 (2)
3:15 pm - 4:30 pm >	WG Gas Interpretation Guide C57.104	IF	C. Beauchemin	220 MX S1	Marriott 5 (2)
3:15 pm - 4:30 pm	TF Switching Transients Induced by Transf/Breaker Interaction PC57.142	PCS	J. McBride	220 MX S1	Marriott 6 (2)
4:30 pm - 4:45 pm	<i>Break (beverages only)</i>				First & Second Levels
	WG Tank Pressure Coordinat. C57.12.39	Dist	Work is complete. Document sent to Revcom.		
4:45 pm - 6:00 pm	WG Std Transf. Terminology C57.12.80	Stds	C. Clairborne	90 MX	Kentucky F (1)
4:45 pm - 6:00 pm	--	--	--	90 MX	Kentucky G (1)
4:45 pm - 6:00 pm	WG Dry Type Test Code C57.12.91	Dry	D. Foster	140 MX S3	Marriott 1-3 (2)
4:45 pm - 6:00 pm	WG Short Circuit Withstand PC57.164	PCS	S. Patel	140 MX S3	Marriott 7-9 (2)
> 4:45 pm - 6:00 pm	WG Gas Interpretation Guide C57.104	IF	C. Beauchemin	220 MX S1	Marriott 5 (2)
4:45 pm - 6:00 pm	TF Revisions to Impulse Test Sections of C57.12.00 and C57.12.90	DiTests	P. Riffon	220 MX S1	Marriott 6 (2)
4:45 pm - 6:00 pm	<u>Technical Tour #2A & 2B: FirstBuild Microfactory (identical tours on Monday & Tuesday).</u>				
6:15 pm - 7:30 pm	--- Advance registration necessary. Dinner on your own (eat before or after tour). See flyer for more info. -- Paper tickets will not be provided. Admission confirmed with RFID badge at bus (<u>bring your name badge!</u>). -- Tour #2A: Begin loading bus at hotel at ~4:30 pm and <u>depart promptly at 4:45 pm.</u> Return at ~6:00 pm. -- Tour #2B: Begin loading bus at hotel at ~6:00 pm and <u>depart promptly at 6:15 pm.</u> Return at ~7:30 pm.				

Wednesday, November 1 -- Wednesday Breaks Sponsored by Northern Transformer Corporation **

No Meeting Registration, No Technical Tours, No Spouse/Companion Tours					
7:00 am - 8:00 am	Breakfast - Attendees (no spouses/companions please)			280 RT (8/tbl)	Kentucky Ballroom A-E (1)
8:00 am - 9:30 am	Breakfast - Spouses/Companions (no meeting attendees please)			80 RT (8/tbl)	Bluegrass 1+2 (2)
<u>7:00 am</u> - 7:50 am	SC Meetings Planning -- Breakfast meeting; arrive early	Mtgs	G. Anderson	24 CL w/buffet in foyer	Filly (2)
<u>7:00 am</u> - 8:30 am	IEC TC-14 Technical Advisory Group -- Breakfast meeting; arrive early -- All interested individuals welcome	++	P. Hopkinson	100 CL w/buffet in room	Kentucky F+G
8:00 am - 9:15 am	SC Instrument Transformers	IT	R. McTaggart	140 MX S3	Marriott 7-9 (2)
8:00 am - 9:15 am	SC Insulation Life	IL	S. Kennedy	360 MX S1 (240 CL+120 TH)	Marriott 5+6 (2)
9:15 am - 9:30 am	<i>Break (beverages only)</i>				Marriott Ballroom Foyer
9:30 am - 10:45 am	SC Bushings	Bush	P. Zhao	140 MX S3	Marriott 7-9 (2)
9:30 am - 10:45 am	SC Distribution Transformers	Dist	S. Shull	360 MX S1	Marriott 5+6 (2)
10:45 am - 11:00 am	<i>Break (beverages only)</i>				Marriott Ballroom Foyer
11:00 am - 12:15 pm	SC UG Transf. & Network Protectors	UTNP	D. Mulkey	140 MX S3	Marriott 7-9 (2)
11:00 am - 12:15 pm	SC Dielectric Tests	DiTests	A. Varghese	360 MX S1	Marriott 5+6 (2)
12:15 pm - 1:30 pm	Lunch (on your own)				
1:30 pm - 2:45 pm	SC Dry Type Transformers	Dry	C. Johnson	140 MX S3	Marriott 7-9 (2)
1:30 pm - 2:45 pm	SC Power Transformers	Power	B. Griesacker	360 MX S1	Marriott 5+6 (2)
2:45 pm - 3:00 pm	<i>Break (beverages and treats)</i>				Marriott Ballroom Foyer
3:00 pm - 4:15 pm	SC Insulating Fluids	IF	D. Wallach	140 MX S3	Marriott 7-9 (2)
3:00 pm - 4:15 pm	SC Performance Characteristics	PCS	E. teNyenhuis	360 MX S1	Marriott 5+6 (2)
4:15 pm - 4:30 pm	<i>Break (beverages only)</i>				
4:30 pm - 5:45 pm	SC Standards	Stds	J. Murphy	140 MX S3	Marriott 7-9 (2)
<u>6:30 pm</u> - 9:30 pm	<u>Evening Event: Dinner Social at The Muhammad Ali Center.</u> Advance registration is necessary. -- Paper tickets will not be provided. Admission confirmed with RFID name badge at entrance of The Center. -- Approx 15-minute walk from hotel (6 blocks). Shuttle bus available if desired. -- Doors open and event <u>begins at 6:30 pm.</u> Exhibits & gift shop open 6:30-7:30 pm. Dinner begins at 7:30 pm.				

KEY

Note: A PC projector will be furnished in each meeting room. Arrive early to ensure equipment operates/syncs correctly.

> -- activity continued into another session / from another session
 ++ -- not a Transformers Committee activity TBD = "To Be Determined"
 S1 = special sound set-up, w/podium & lapel mics, table mics, stand mics at mid-room
 S2 = stand mic in front only; S3 = one stand mic in front & stand mic(s) at mid-room

BD = boardroom; US = U-shape
 RT = multiple roundtables
 CL = classroom seating (w/head table for 2)
 TH = theater seating (w/head table for 2)
 MX = mix classroom & theater (w/head table)

SUBCOMMITTEES					
Admin	Administrative	HVDC	HVDC Converter Transformers and Smoothing Reactors	Mtgs	Meetings
Bush	Bushings			PCS	Performance Characteristics
DiTests	Dielectric Tests	IF	Insulation Fluids	Power	Power Transformers
Dist	Distribution Transformers	IL	Insulation Life	UTNP	Underground Transformers and Network Protectors
Dry	Dry Type Transformers	IT	Instrument Transformers		
				Stds	Standards

Thursday, November 2

No Socials or Technical Tours					
7:00 am - 8:30 am	Breakfast - Attendees (no spouses/companions please)			280 RT (8/tbl)	Kentucky Ballroom A-E (1)
8:00 am - 9:30 am	Breakfast - Spouses/Companions (no meeting attendees please)			80 RT (8/tbl)	Bluegrass 1+2 (2)
8:00 am - 9:15 am	Technical Presentation #1: "Sound Pressure Levels for Power Transformer Specifications"; by Girgis & Howell. See flyer on website. **			400 MX S1 (240 CL+160 TH)	Marriott 5+6 (2)
9:15 am - 9:30 am	Break (beverages only)				Marriott Ballroom Foyer
9:30 am - 10:45 am	Technical Presentation #2: "Review of Loss Evaluation Guide, C57.120"; by Binder, Sauls, Schrammel, Verdolin. See flyer on website. **			400 MX S1	Marriott 5+6 (2)
10:45 am - 11:00 am	Break (beverages only)				Marriott Ballroom Foyer
11:00 am - 12:00 pm	Closing Session -- All attendees are encouraged to attend -- See separate document for meeting agenda	S. Antosz		400 MX S1	Marriott 5+6 (2)
Lunch on your own					
> 1:30 pm - 5:00 pm >	WG Tap Changer Application Guide IEC/IEEE 60214-2 (continued from Tuesday afternoon)	Power	A. Kraemer	20 BD	Rose (2)

Friday, November 3

No Socials or Technical Tours					
> 8:00 am - 5:00 pm	WG Tap Changer Application Guide IEC/IEEE 60214-2	Power	A. Kraemer	20 BD	Rose (2)

** Contact Tom Prevost (tprevost@ieee.org) if you are interested in making a technical presentation at a future meeting.

FUTURE COMMITTEE MEETINGS

Spring 2018: March 25-29; Pittsburgh, Pennsylvania USA -- Our 100th Year Anniversary Celebration!

Fall 2018: October 14-18; Jacksonville, Florida USA

Spring 2019: March 10-14 or 17-21 or 24-28; USA Location, to be determined

Marriott Louisville Downtown Hotel

280 West Jefferson Street
Louisville, Kentucky 40202 USA
+1.502.627.5045

SECOND LEVEL (2)

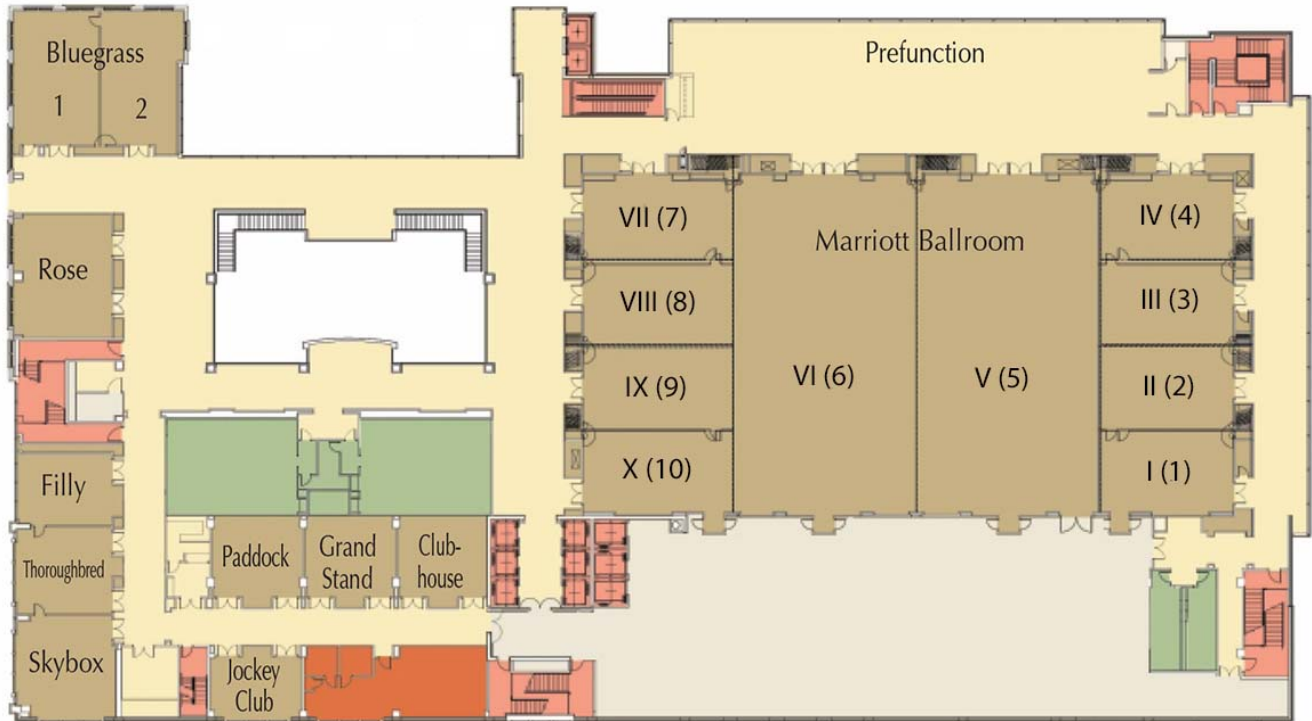

FIRST LEVEL (1)

